



If your child is stung at school, the nurse will institute the following **Emergency Protocol:**

1. Medical management as prescribed above
2. Application of ice, elevate extremity, removal of stinger
3. **911 CALLED** in severe emergency and/or if **epinephrine** was used
4. Parent or emergency contact will be called
5. The child's doctor will be called if parent or emergency contact cannot be reached.

**EMERGENCY CONTACT INFORMATION:**

Name	Relationship to Child	Phone Numbers
<hr/>		
<hr/>		

Physician Name \_\_\_\_\_ Phone Number \_\_\_\_\_

*The insect sting management plan may be shared with school staff to support your child's safety in school. Parents are encouraged to discuss their child's medical needs with the transportation department as well as sponsors/coaches working with your child before or after school hours.*

Parent Signature \_\_\_\_\_ Date \_\_\_\_\_

**Directions for Epinephrine Autoinjectors: If an Epinephrine Autoinjector is used ALWAYS call 911**

**EpiPen® and EpiPen® Jr. Directions**

- Pull off gray activation cap.
- Hold black tip near outer thigh (always apply to thigh).
- Swing and jab firmly into outer thigh until Auto-Injector mechanism functions.
- Hold in place and count to 10.
- Remove the EpiPen® unit and massage the injection area for 10 seconds.
- Give the EpiPen® unit to the emergency personnel; take care not to touch exposed needle
- If symptoms don't improve after 10 minutes, a second dose may be administered

**Auvi-Q® Directions**

**1. Pull Auvi-Q® from the outer case** Do not proceed to step 2 until you are ready to use Auvi-Q®. If not ready to use, replace the outer case.

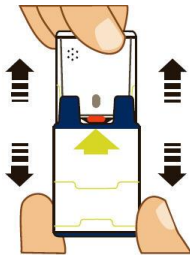

**2. Pull off Red safety guard** To avoid an accidental injection, **never** touch the black base of the auto-injector. If an accidental injection does occur, seek medical help immediately. NOTE: The safety guard is meant to be tight. **Pull firmly to remove.**

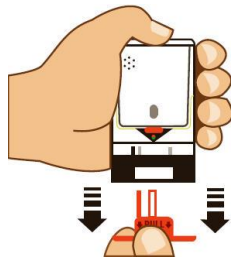

**3. Place black end against the middle of the outer thigh (through clothing, if necessary), then press firmly and hold in place for 5 seconds.** Each device is a single-use injection. Only inject into the middle of the outer thigh (upper leg). Do not inject into any other location. Note: Auvi-Q® makes a distinct sound (click and hiss) when activated. This is normal and indicates Auvi-Q® is working correctly. Do not pull Auvi-Q® away from your leg when you hear the click and hiss sound.

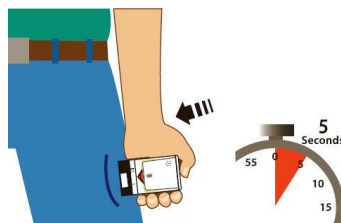

**4. Seek medical attention immediately**

Replace the outer case and take your used Auvi-Q® with you to a healthcare professional for proper disposal and a prescription refill.